

## PROGRAM

### 66<sup>th</sup> Annual Meeting of the Northeastern Weed Science Society

***THEME: Weed Science Funding:  
New Avenues for a Changing  
Landscape***



**Sheraton Society Hill Hotel  
Philadelphia, PA**

**January 3 - 6, 2012**



**Annual Meeting of Northeast Region –  
American Society for Horticultural Science**

## **Meeting Location**

**Sheraton Society Hill Hotel  
One Dock Street  
Philadelphia, PA 19106  
(215) 238-6000**

## **Hotel Website**

**[www.sheraton.com/societyhill](http://www.sheraton.com/societyhill)**

## **Room Registration Website**

**[66th Annual Meeting of the Northeastern Weed  
Science Society](#)**

**DOWNLOAD PRESENTATIONS AT  
REGISTRATION DESK**

**USB DRIVES REQUIRED**

**Deadline for Downloading  
Presentations:**

***NEWSS Graduate Students*  
Tuesday Jan 3<sup>rd</sup> 6:30 p.m.**

***All Other NEWSS Presentations*  
Wednesday Jan 4<sup>th</sup> 8:45 a.m.**

**Prefunction Lobby**



**The Northeastern Weed Science Society**  
**P.O. Box 307**  
**Fredericksburg, PA 17026**  
**[www.NEWSS.org](http://www.NEWSS.org)**

## Platinum Level



Bayer CropScience

## Gold Level



## Silver Level



BAAR Scientific LLC



## Bronze Level

ACDS Research  
Reality research  
LABServices

## Meeting Location

Sheraton Society Hill Hotel  
One Dock Street  
Philadelphia, PA 19106  
(215) 238-6000

## Directions and Transportation

**Shuttle from airport** available through Lady Liberty Shuttle Service: <http://www.ladylibertyshuttle.com/>

### **From Philadelphia International Airport (South)**

Take Interstate 95 North to Exit 20 (Columbus Boulevard). Turn left at the traffic light onto Columbus. Turn left turn at the sixth light, for Dock Street. Turn right at the stop sign. The hotel is on the right-hand side.

### **From East**

Take Ben Franklin Bridge from Camden, stay in the right lane. Take the first right off of bridge to Sixth Street then follow Sixth Street to Market Street and turn left. Follow Market to Second Street and turn right. Follow Second Street to Dock Street and the hotel is on the left.

### **From North**

Take Interstate 95 South to Exit 20 (Columbus Boulevard). At the bottom of the ramp, turn left onto Columbus Boulevard. Follow for 3 traffic lights to Dock Street and turn left. Continue to a dead end and turn right. The hotel will be on the right.

### **From West**

Take Pennsylvania Turnpike to 76 East (Exit 326 - Valley Forge). Follow 76 East to 676 East (Exit 344 - Central Philadelphia). Continue on 676 East to Interstate 95 South. Take I-95 South to Penn's Landing (Exit 20). At the bottom of the ramp, turn left onto Columbus Boulevard. Follow to Dock Street and turn left. Continue to the dead end and turn right. The hotel is on the right-hand side.

## **Make Plans for the 2013 Joint Meeting with WSSA:**

February 4 - 7, 2013

Monday through Thursday

Location: Hilton, Baltimore, MD

# Sheraton Society Hill Hotel Floor Plan

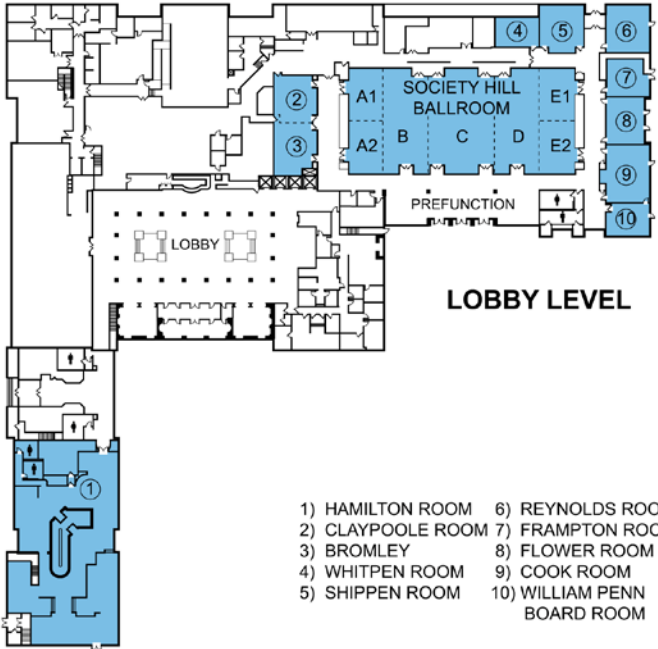

# **NORTHEASTERN WEED SCIENCE SOCIETY**

[www.NEWSS.org](http://www.NEWSS.org)

**Sheraton Society Hill Hotel  
Philadelphia, PA**

## **EXECUTIVE COMMITTEE OFFICERS**

- President**                      **M.J. VanGessel**  
University of Delaware  
16483 County Seat Highway  
Georgetown, DE 19947  
mjv@udel.edu
- President-Elect**                **A. DiTommaso**  
Cornell University  
903 Bradfield Hall  
Ithaca, NY 14853  
ad97@cornell.edu
- Vice-President**                **D.D. Lingenfelter**  
Penn State University  
116 ASI Building  
University Park, PA  
dxl18@psu.edu
- Secretary/Treasurer**        **M.A. Bravo**  
Pennsylvania Department of  
Agriculture  
2301 North Cameron Street  
Harrisburg, PA 17110  
mab36@psu.edu
- Past President**                **H.A. Sandler**  
UMass Cranberry Station  
P.O. Box 569  
East Wareham, MA 02538  
hsandler@umext.umass.edu

## COMMITTEES

### Editor

#### **D.W. Lycan**

Syngenta Lawn and Garden  
18 Appleridge St.

Baldwinsville, NY 13027

darren.lycan@syngenta.com

### Public Relations

#### **B.A. Scott**

University of Delaware

16483 County Seat Highway

Georgetown, DE 19947

bascott@udel.edu

### Research & Education Coordinator

#### **J.B. Willis**

Monsanto Company

1305 Sanders Road

Troy, OH

john.b.willis@monsanto.com

### Sustaining Membership

#### **J.H. O'Barr**

BASF Corporation

106 Whippoorwill Lane

Hummelstown, PA 17036

john.obarr@basf.com

### CAST Representative

#### **R.G. Probst**

University of Massachusetts

Bowditch Hall, Rm 206

Amherst, MA 01003

rprobst@umext.umass.edu

### Graduate Student Representative

#### **A.N. Smith**

Virginia Tech

435 Old Glade Road

Blacksburg, VA 24061

urzsmith@vt.edu

### WSSA Representative

#### **J.N. Barney**

Virginia Tech

435 Old Glade Road

Blacksburg, VA 24061

jnbarney@vt.edu

---

---

## **COMMITTEE MEETINGS**

---

---

### **EXECUTIVE COMMITTEE MEETINGS**

**Tuesday, January 3**

2:00 p.m. - 4:30 p.m. William Penn Boardroom

**Friday, January 6**

Executive Committee (Old and New)

7:00 a.m. - 7:30 a.m. Breakfast, Lounge

7:30 a.m. - 8:15 a.m. Meeting,  
Cook Room

### **AWARDS COMMITTEE MEETING**

**Tuesday, January 3**

5:00 p.m. - 5:30 p.m. Flower Room

### **WEED SCIENCE FIELD DAY COMMITTEE**

**Tuesday, January 3**

5:00 p.m. - 5:15 p.m. William Penn Boardroom

### **COLLEGIATE WEED CONTEST COMMITTEE**

**Tuesday, January 3**

5:15 p.m. - 6:00 p.m. William Penn Boardroom

### **PROGRAM COMMITTEE MEETING**

**Tuesday, January 3**

5:30 p.m. - 6:00 p.m. Cook Room  
(Moderators, Section  
Chairs, Chairs-Elect)

### **AUDIT COMMITTEE**

**Tuesday, January 3**

6:30 p.m. - 7:00 p.m. Registration Desk

**STUDENT PAPER JUDGING  
COMMITTEE MEETING**

**Tuesday, January 3**

5:30 p.m. - 6:00 p.m. Flower Room

**Wednesday, January 4**

5:30 p.m. - 6:30 p.m. Flower Room

**Thursday, January 5**

11:30 a.m. - 1:00 p.m. Taste Restaurant

**PHOTO JUDGING COMMITTEE MEETING**

**Tuesday, January 3**

6:00 p.m. - 7:00 p.m. William Penn Boardroom

**POSTER JUDGING COMMITTEE MEETING**

**Wednesday, January 4**

7:30 a.m. Ballroom A&B

**NEASHS BUSINESS MEETING**

**Wednesday, January 4**

4:45 p.m. - 5:45 p.m. Bromley/Claypoole

**PAST PRESIDENTS' BREAKFAST  
MEETING**

**Thursday, January 5**

7:00 a.m. - 7:30 a.m. Breakfast, Taste

7:30 a.m. - 8:15 a.m. Meeting,  
Taste Restaurant

## **NEWSS REGISTRATION**

**Tuesday, January 3**

4:30 p.m. - 6:30 p.m. Prefunction Lobby

**Wednesday, January 4**

7:30 a.m. - 4:00 p.m. Prefunction Lobby

**Thursday, January 5**

8:00 a.m. - 3:00 p.m. Prefunction Lobby

**Friday, January 6**

8:00 a.m. - 11:00 a.m. Prefunction Lobby

## **NEASHS REGISTRATION**

**Tuesday, January 3**

4:30 p.m. - 6:30 p.m. Prefunction Lobby

**Wednesday, January 4**

7:30 a.m. - 10:00 a.m. Prefunction Lobby

**Thursday, January 5**

8:00 a.m. - 9:00 a.m. Prefunction Lobby

**Please download your presentations  
at the Registration Desk when you  
register at the meeting!!**

USB memory sticks required

**Deadline for Downloading NEWSS  
Presentations:**

***NEWSS Graduate Students*  
Tuesday 6:30 p.m.**

***All Other NEWSS Presentations*  
Wednesday 8:45 a.m.**

---

---

## CONDENSED PROGRAM

---

---

### *TUESDAY JANUARY 3*

- 2:00 p.m. - 7:00 p.m.      Committee Meetings
- 2:00 p.m. - 5:00 p.m.      NE-1047 Committee Meeting  
Frampton Room
- 4:30 p.m. - 5:30 p.m.      Drop Off Photos for Photo Judging at Registration Desk  
Prefunction Lobby
- 4:30 p.m. - 6:30 p.m.      NEWSS Registration  
Prefunction Lobby
- 4:30 p.m. - 6:30 p.m.      NEASHS Registration  
Prefunction Lobby
- 4:30 p.m. - 10:00 p.m.      NEWSS / NEASHS Posters Set-Up  
Ballroom A&B
- 4:30 p.m. - 10:00 p.m.      Commercial Displays Set-up  
Ballroom A&B
- 6:30 p.m.                      **Deadline for NEWSS Contest Graduate Students to Load Presentations**
- 6:30 p.m. - 8:00 p.m.      NEWSS / NEASHS Student Mixer  
Presidential Suite

## **WEDNESDAY JANUARY 4**

- 7:30 a.m. Poster Judging Committee  
Ballroom A&B
- 7:30 a.m. - 4:00 p.m. NEWSS Registration  
Prefunction Lobby
- 7:30 a.m. - 10:00 a.m. NEASHS Registration  
Prefunction Lobby
- 7:45 a.m. - 9:00 a.m. NEWSS / NEASHS  
Posters (authors present)  
Commercial Displays,  
Coffee  
Ballroom A&B
- 8:45 a.m. **Deadline** to Load NEWSS  
Presentations  
Prefunction Lobby
- 9:00 a.m. - 12:00 p.m. General Session and  
Symposium  
Society Hill Ballroom C&D
- 1:30 p.m. - 5:30 p.m. Graduate Student Session  
Society Hill Ballroom C&D
- 1:30 p.m. - 2:45 p.m. Weed Biology & Ecology  
Ballroom E
- 1:30 p.m. - 4:45 p.m. NEASHS Paper Session  
Bromley/Claypoole Room
- 3:45 p.m. - 5:15 p.m. Ornaments  
Ballroom E
- 4:45 p.m. - 5:45 p.m. NEASHS Business  
Meeting and Student  
Awards  
Bromley/Claypoole Room

5:30 p.m. - 6:30 p.m. Student Paper Judging  
Committee  
Flower Room

6:30 p.m. - 8:30 p.m. NEWSS / NEASHS  
Social Mixer  
Hamilton

### ***THURSDAY JANUARY 5***

7:00 a.m. - 7:30 a.m. Past-Presidents' Breakfast  
Taste Restaurant

7:30 a.m. - 8:15 a.m. Past-Presidents' Meeting  
Taste Restaurant

8:00 a.m. - 3:00 p.m. NEWSS Registration  
Prefunction Lobby

8:00 a.m. - 9:00 a.m. NEASHS Registration  
Prefunction Lobby

8:00 a.m. - 8:00 p.m. NEWSS / NEASHS  
Research Posters  
(authors not present) &  
Commercial Displays  
Ballroom A&B

8:30 a.m. - 11:00 a.m. Ornaments  
Ballroom E

8:30 a.m. - 11:00 a.m. Graduate Student Session  
Society Hill Ballroom C&D

8:30 a.m. - 11:30 a.m. NEASHS Oral  
Presentations  
Bromley/Claypoole Room

10:15 a.m. - 11:45 a.m. Vegetables & Fruit  
Cook

- 11:30 a.m. - 1:00 p.m. Student Paper Judging  
Committee  
Taste Restaurant
- 1:00 p.m. - 4:30 p.m. Symposium: Moving  
beyond rotating modes of  
action: Advancing the  
concept and application of  
integrated weed  
management  
Society Hill Ballroom C&D
- 1:00 p.m. - 2:30 p.m. Mini-symposium: Update  
on swallow-wort ecology &  
management  
Ballroom E
- 2:30 p.m. - 4:30 p.m. Vegetation Management  
and Restoration  
Ballroom E
- 4:45 p.m. - 6:15 p.m. NEWSS Annual Business  
Meeting & Awards  
Society Hill Ballroom C&D
- 6:00 p.m. - 9:00 p.m. NEWSS / NEASHS Poster  
Take Down
- 9:00 p.m. - 11:00 p.m. Industry Night Cap and  
Dessert Social  
NEWSS / NEASHS  
Hamilton Room

## ***FRIDAY JANUARY 6***

- 7:00 a.m. - 7:30 a.m. Executive Committee  
(Old and New) Breakfast,  
Lounge

7:30 a.m. - 8:15 a.m.	Executive Committee (Old and New) Meeting, Cook Room
8:00 a.m. - 11:00 a.m.	NEWSS Registration Prefunction Lobby
8:15 a.m. - 12:00 p.m.	Agronomy Ballroom C&D
8:15 a.m. - 12:00 p.m.	Turfgrass and Plant Growth Regulators Ballroom E
12:00 p.m.	Adjourn

# PROGRAM

---

---

**WEDNESDAY MORNING JANUARY 4**

---

---

**Section: NEWSS - NEASHS POSTERS**  
**(Authors Present)**

LOCATION: Ballroom A&B  
TIME: 7:45 a.m. to 9:00 a.m.  
CHAIR: Kathleen Hester  
IR-4 Project  
Princeton, NJ

CHAIR-ELECT: Jennifer D'Appollonio  
University of Maine  
Orono, ME

**\*Presenter †Student Poster**

**The Sinnemahonning Cooperative Weed Management Area (SIPMA) Gets to Work.** T.J. Meyer, J. Zoschg and M.A. Bravo\*, Pennsylvania Department of Agriculture, Harrisburg, PA (1)

**Giant Hogweed Eradication in Pennsylvania and the United States.** M.A. Bravo\*, I.D. Bowers, and J. Zoschg, Pennsylvania Department of Agriculture, Harrisburg, PA (2)

**†Comparing Herbicide Tolerances of Rare and Common Plants in Lancaster County, PA.** I.M. Graham\*, J.F. Egan, and D. Mortensen, Penn State University, University Park, PA (3)

**Effect of Nozzle Type, Spray Droplet Size and Spray Volume on Crop Tolerance and Weed Control with Enlist Duo.** B.D. Olson\*, D.M.

Simpson, D.E. Hillger, C.C. Love, and D.T. Ellis, Dow AgroSciences LLC, Geneva, NY (4)

**Modeling of Volatility of 2,4-D Ester, DMA and Choline Formulations.** B.D. Olson\*, D.E. Hillger, P. Havens, J.A. Huff, R.B. Lassiter, and J.S. Richburg, Dow AgroSciences LLC, Geneva, NY (5)

**Methodology for Utilizing Low Tunnel Structures to Evaluate Differences in Herbicide Volatility.** B.D. Olson\*, D.D. Ruen, D.E. Hillger, and E.F. Scherder, Dow AgroSciences LLC, Geneva, NY (6)

**†Effects of Methiozolin Rates on Creeping Bentgrass and Annual Bluegrass Root Growth.** K.A. Venner\*, S. Askew, and S-J. Koo, Virginia Tech, Blacksburg, VA (7)

**Crop Rotation: Sequence Benefits and Problems.** C.L. Mohler\*, Cornell University, Ithaca, NY (8)

**Herbicide Evaluation for Watermelon Grown with Plasticulture.** S.A. Mathew\*, B.A. Scott, and M.J. VanGessel, University of Maryland, Cambridge, MD (9)

**†Evaluation of Paclobutrazol Formulations and Rates for Annual Bluegrass Control on Putting Greens.** A. Post\*, S. Askew, M.C. Cox, and J. Corbett, Virginia Tech, Blacksburg, VA (10)

**Effect of Weed Removal Timing in Corn as Influenced by Nitrogen Source and Rate.** W.J. Everman\*, A. Knight, and J. Hinton, North Carolina State University, Raleigh, NC (11)

**A New Pocket Scouting Guide for Aquatic Weeds.** B. Lassiter, R.J. Richardson\*, and G. Wilkerson, North Carolina State University, Raleigh, NC (12)

**†Hairy Vetch Seedbank Persistence as Influenced by Mechanical Scarification and Soil Depth.** B.C. Crockett\*, S. Mirsky, and W.S. Curran, Penn State University, University Park, PA (13)

**Impacts of Invasive *Ambrosia artemisiifolia* on Soil Enzyme Activity and Fertility.** Q. Zhong\*, X. Junfang, Q. Guoming, Z. Jia-en, M. Danjuan, and A. DiTommaso, South China Agricultural University, Guangzhou, China (14)

**Physiological and Morphological Responses of Invasive *Ambrosia artemisiifolia* to Different Irradiances.** M. Danjuan, Q. Zhong\*, Q. Guoming, Z. Jia-en, X. Junfang, and A. DiTommaso, South China Agricultural University, Guangzhou, China (15)

**Modelling the Potential Distribution of Invasive *Ambrosia artemisiifolia* in China.** Q. Zhong\*, A. DiTommaso, C.L. Mohler, and Z. Jia-en, South China Agricultural University, Guangzhou, China (16)

**†Seedling Emergence of Several Weed Species as Affected by Furrow Location, Corn Planting Density and Pattern.** F. Kordbacheh\*, H.R. Mashhadi, and A. DiTommaso, University of Tehran, Tehran, Iran (17)

**The Effect of Timing and the Method of Control on Japanese Stiltgrass Seed Production.** J.L. Huffman\*, E.S. Rauschert, A.E.

Gover, and A.N. Nord, Penn State University, University Park, PA (18)

**Preliminary Characterization of Dicamba Performance in Dicamba Tolerant Soybeans in the Northeast.** D.J. Mayonado\*, R.L. Ritter, M.J. VanGessel, and H.P. Wilson, Monsanto, Salisbury, MD (19)

**†Sweet Vernalgrass: A New Weed Problem for Northeastern Turfgrass.** A.N. Smith\* and S. Askew, Virginia Tech, Blacksburg, VA (20)

**Weed Management with Tembotrione and Isoxaflutole in North Carolina.** W.J. Everman\*, J. Hinton, and M. Rosemond, North Carolina State University, Raleigh, NC (21)

**†Investigating Pokeweed Management in Field Crops.** K.M. Patches\* and W.S. Curran. Penn State University, University Park, PA (22)

**Mechanical and Cultural Effects on Lima Bean Weed Control.** B.A. Scott\*, M.J. VanGessel, and Q. Johnson, University of Delaware, Georgetown, DE (23)

**The Weed Olympics: A National Weed Science Contest.** J.T. Brosnan\*, G. Armel, G.K. Breeden, J.J. Vargas, and M.J. VanGessel, University of Tennessee, Knoxville, TN (24)

**†Tank Mixtures and Application Intervals for Smooth Crabgrass Control with Metamifop.** M.C. Cox\* and S. Askew, Virginia Tech, Blacksburg, VA (25)

**Tall Fescue Tolerance to Tower® (dimethenamid) and Freehand™ (dimethenamid + pendimethalin).** D. Gomez de

Barreda\*, and P. McCullough, Polytechnic University of Valencia, Valencia, Spain (26)

**Specialty Greens & Herbs - Surveying Ethnic Consumer Preferences for the East Coast.**

R. Govindasamy, J. Simon, W. Sciarappa\*, R. Van Vranken, A. Ayeni, P. Nitzsche, B. Schilling, S. Komar, V. Puduri, Rutgers University, New Brunswick, NJ; K. M. Kelley, Penn State University, University Park, PA; F. Mangan, University of Massachusetts, Amherst, MA; S. Zhang, and G. McVaoy, University of Florida, Gainesville (27)

**Results of Application of Coragen® (Rynaxypyr®) on Reduction of Sunflower Moth Larvae Damage.** J. Carleo\*, C. A. Wyenandt, D. Ward, G. Ghidiu, Rutgers University, New Brunswick, NJ and W. Autio, University of Massachusetts, Amherst, MA (28)

**Education and Outreach through Gardening with Home-Schooled and Special Needs Youth.** M. Cummings\*, Rutgers University, New Brunswick, NJ (29)

**High Tunnel Colored Bell Pepper Variety Trial – First Year Results.** T. Elkner\* and S. Bogash, Penn State University, University Park, PA (30)

**Enabling Gardens - Rutgers and Rotary: Growing Lives One Seed at a Time.** N. Polanin\* and L. DePrado, Rutgers University, New Brunswick, NJ (31)

**Salinity Tolerance of Sea-Beach Amaranth (*Amaranthus pumilus* Raf.) in Comparison with the Grain Amaranths (*Amaranthus cruentus* L. and *Amaranthus hypochondriacus* L.).** S.W. Eisenman\* and I. Zeitzer, Temple

University, Philadelphia, PA (32)

**Effects of Systemm-CAL and ProGibb on PF-14 Jersey Peaches in Massachusetts and New Jersey.** W. Autio, J. Krupa, University of Massachusetts, Amherst, MA.; W. Cowgill\*, D. Ward, R. Magron, and S. Sollner-Figler, Rutgers University, New Brunswick, NJ (33)

**Rain Gardens: Veterans Application of Horticultural Training to Storm Water Management.** A. Rowe and J. Zientek\*, Rutgers University, New Brunswick, NJ (34)

**Oxygen and Ethylene-Induced Germination in Recalcitrant Peach Seeds.** C. Frenkel\*, R.D. Belding, G. Williams-Lokaj, Rutgers University, New Brunswick, NJ; and G.L. Reighard, Clemson University, Clemson, SC (35)

**†Identification and Characterization of New Sources of Resistance to Eastern Filbert Blight from *Corylus avellana* Collections in Russia, Ukraine, and Poland.** J. Capik\*, C. Leadbetter, M. Muehlbauer, and T. Molnar, Rutgers University, New Brunswick, NJ (36)

**†Patterns in Root Radial Growth of *Acer saccharinum* L. in Response to Wind Loading Patterns with Increasing Distance from the Trunk.** I. Donne\* and J. Grabosky, Rutgers University, New Brunswick, NJ (37)

---

---

**WEDNESDAY MORNING JANUARY 4**

---

---

**GENERAL SESSION**

LOCATION: Society Hill Ballroom C&D  
TIME: 9:00 a.m. to 12:00 p.m.  
MODERATOR: Antonio DiTommaso  
Cornell University  
Ithaca, NY

**Welcome Address**

**Bruce A. McPheron**  
Dean, College of Agricultural Sciences  
Penn State University  
University Park, PA

**Presidential Address**

**"I study weeds; No, seriously, I really do"**  
Mark VanGessel  
University of Delaware  
Georgetown, DE

**SYMPOSIUM:**

**Weed Science Funding: New  
Avenues for a Changing Landscape**

**Invited Speakers:**

**Funding of Agricultural Programs in Land-  
Grant Institutions**  
Bruce A. McPheron

Dean, College of Agricultural Sciences  
Penn State University  
University Park, PA

**Outcome Funding and the Northeast  
Sustainable Agriculture Research and  
Education (SARE) Grant Program**

Thomas Morris  
Professional Development Program  
Northeast Sustainable Agriculture Research  
and Education Program (SARE)  
University of Connecticut  
Storrs, CT

**USDA-ARS Weed Science Funding**

John Lydon  
USDA, ARS, Office of National Programs  
National Program Leader, Weed Science  
Beltsville, MD

**Show Me the Money! Weed's Won't Wait,  
Don't Hesitate**

Lee Van Wychen  
Science Policy Director  
National and Regional Weed Science  
Societies  
Alexandria, VA

---

---

**WEDNESDAY AFTERNOON JANUARY 4**

---

---

**Section: STUDENT PRESENTATIONS**

LOCATION: Society Hill Ballroom C&D  
TIME: 1:30 p.m. to 5:30 p.m.  
MODERATORS: Adam Smith  
Virginia Tech  
Blacksburg VA  
Angela Post  
Virginia Tech  
Blacksburg VA

**\*SPEAKER**

- 1:30 Effect of Saflufenacil Application Timing on Soybean and its Role in Managing Glyphosate-Resistant Horseweed.** J.T. Ikley\* and R.L. Ritter, University of Maryland, College Park, MD
- 1:45 Absorption, Translocation, and Metabolism of Aminocyclopyrachlor in Loblolly Pine (*Pinus taeda*).** R.L. Roten\* and R.J. Richardson, North Carolina State University, Raleigh, NC
- 2:00 Control of Annual Bluegrass Biotypes With Three Postemergent Herbicides.** K.M. Han\* and J.E. Kaminski, Penn State, University Park, PA

- 2:15 Herbicidal Activity of Heterocyclic Analogues of Dichlobenil on Various Weed and Ornamental Species.** J.W. Thomas\*, G. Armel, M.D. Best, W.M. Klingeman, C-L. Do-Thanh, and H.E. Bostic, University of Tennessee, Knoxville, TN
- 2:30 Evaluation of Aminocyclopyrachlor for Control of Invasive Plant Species in Tennessee.** J.J. Vargas\*, G. Armel, W.M. Klingeman, P. Flanagan, R.M. Evans, R.J. Richardson, and R.L. Roten, University of Tennessee, Knoxville, TN
- 2:45 Fine Fescue Varietal Tolerance to Glyphosate Rates.** M.C. Cox\*, S. Askew, W. Askew, and J.M. Goatley Jr., Virginia Tech, Blacksburg, VA
- 3:00 Effects of Rooting Depth on Hybrid Bermudagrass (*C. dactylon* x *C. transvaalensis*) Injury with Indaziflam in Various Soils.** P.A. Jones\*, J.T. Brosnan, G.K. Breeden, and M. Elmore, University of Tennessee, Knoxville, TN
- 3:15 Break – Coffee/Beverages on your own**
- 3:45 Effect of Corn Herbicides on Successful Cover Crop Establishment.** C.S. Dillon\* and W.S. Curran, Penn State, University Park, PA
- 4:00 Partitioning Out the Effects of Nutrients from Composted Manure on Weeds and Crops.** N.G. Little\*, C.L. Mohler, A. DiTommaso, and Q.M. Ketterings, Cornell University, Ithaca, NY

- 4:15 Effects of Soil Management Legacy on Weed-Crop Competition.** H.J. Poffenbarger\*, S. Mirsky, J. Teasdale, J. Spargo, D. Timlin, J. Maul, and M. Cavigelli, USDA-ARS, Beltsville, MD
- 4:30 Evaluating Integrated Weed Management for No-Till Dairy Cropping Systems.** E.M. Snyder\*, W.S. Curran, H.D. Karsten, and G.M. Malcolm. Penn State, University Park, PA
- 4:45 The Effect of Row Spacing on Weed Pressure, Yield and Economics in Soybean.** J.M. Orlowski\*, W.J. Cox, and A. DiTommaso, Cornell University, Ithaca, NY
- 5:00 Effectiveness of Shallow High-Residue Cultivation in No-Till Soybean.** W.S. Curran and C.L. Keene\*, Penn State, University Park, PA
- 5:15 Impact of Soil Moisture Content on Preemergence Weed Control Using Microwave Radiation.** A. Rana\* and J.F. Derr, Virginia Tech, Blacksburg, VA
- 5:30 Adjourn**

---

---

**WEDNESDAY AFTERNOON JANUARY 4**

---

---

**Section: WEED BIOLOGY AND ECOLOGY**

LOCATION: Ballroom E  
TIME: 1:30 p.m. to 2:45 p.m.  
CHAIR: Jacob Barney  
Virginia Tech,  
Blacksburg, VA  
CHAIR-ELECT: Katie Ghantous  
UMass Cranberry Station  
East Wareham, MA

**\*SPEAKER**

- 1:30 The Non-Native Vascular Flora of Monomoy Islands, Massachusetts.** R. Stalter\*, St. John's University, Queens, NY
- 1:45 Compost Increases Weed Abundance in an Organic Grain Cropping System.** C.A. Marschner\*, C.L. Mohler, B.A. Caldwell, and A. DiTommaso. Cornell University, Ithaca, NY
- 2:00 Initial Investigations into Dodder Species Variation in Southeastern Massachusetts.** K.M. Ghantous\*, S. Stefanovic, and H.A. Sandler, UMass Cranberry Station, East Wareham, MA
- 2:15 Early Season Phenological Indicators of Cereal Rye Performance.** S. Mirsky\*, J. Spargo, W. Curran, M. Ryan, and S.C. Reberg-Horton, USDA-ARS, Beltsville, MD

**2:30 Discussion, Section Business Meeting,  
and Election of Chair-Elect**

---

---

**WEDNESDAY AFTERNOON JANUARY 4**

---

---

**Section: ORNAMENTALS**

LOCATION: Ballroom E  
TIME: 3:45 p.m. to 5:15 p.m.  
CHAIR: Chris Becker  
BAAR Scientific LLC  
Romulus, NY  
CHAIR-ELECT: Kathleen Hester  
The IR-4 Project  
Exton, PA

**\*SPEAKER**

- 3:45 Bedding Plant Response to  
Dimethenamid.** J.F. Derr\*, Virginia Tech,  
Virginia Beach, VA
- 4:00 Early Postemergence Control of  
Bittercress (*Cardamine hirsuta*) in  
Container Plant Production.** C. Marble\*,  
C. Gilliam, and A. Alexander, Auburn  
University, Auburn, AL
- 4:15 IR-4 2011 Crop Injury Summary of  
Several Herbicides on Ornamental  
Nursery Crops.** K.A. Hester\*, C.L.  
Palmer, E. Vea, and J. Baron, IR-4  
Project, Princeton, NJ

- 4:30 IR-4 2011 Summary of Postemergent Liverwort Control in Nursery Containers.** K.A. Hester\*, C.L. Palmer, E. Lurvey, and J. Baron, IR-4 Project, Princeton, NJ
- 4:45 Phenoxy Herbicide Safety in Container Production of *Muhlenbergia* and *Miscanthus*.** C. Harlow\* and J.C. Neal, North Carolina State University, Raleigh, NC
- 5:00 Tolerances of Container-Grown Ornamentals to Mesotrione, Dimethenamid-P, and Pendimethalin plus Dimethenamid-P Applications.** T.L. Mervosh\* and J.F. Ahrens, Connecticut Agricultural Experiment Station, Windsor, CT

---

---

**WEDNESDAY AFTERNOON JANUARY 4**

---

---

**Section: NEASHS PAPERS**

LOCATION: Bromley/Claypoole  
TIME: 1:30 p.m. to 4:45 p.m.  
MODERATOR: Carolyn DeMoranville  
NEASHS President  
UMass Cranberry Station  
E. Wareham, MA

**\*SPEAKER**

**† Student Presentation**

- 1:30 Nitrogen Form and Ratio Affect in Vitro Shoot Multiplication and Growth of Lowbush Blueberry (*Vaccinium angustifolium* Ait.).** J. P. Santiago and J. M. Smagula\*, University of Maine, Orono, ME
- 1:45 Subsurface Tile Drainage Effects in Cranberry Production.** P. Jeranyama\*, J. M. Sack, and C. DeMoranville, University of Massachusetts Amherst, Amherst, MA
- 2:00 Effects of Fertilizer Nitrogen, Magnesium, and Sulfur Rates and Sources on Fruit Skin Color in Pickling Cucumbers.** G.C. Johnson\*, University of Delaware, Georgetown, DE
- 2:15 †Genetic Diversity and Population Structure of the Eastern Filbert Blight Pathogen (*Anisogramma anomala*) and its Implications on Hazelnut Breeding.** C. Leadbetter\*, J. Capik, G. Cai, B. Hillman, and T. Molnar. Rutgers University, New Brunswick, NJ
- 2:30 †Overcoming the Challenges to Switchgrass Production on Small Farms as a Source for Alternative Energy.** W.T. Hlubik, J. Baculis\*, S. Bonos, Z. Helsen, and R. Weidman, Rutgers University, New Brunswick, NJ
- 2:45 †Patterns in Root Radial Growth of *Acer saccharinum* L. in Response to Wind Loading Patterns with Increasing Distance from the Trunk.** I. Donne\* and J. Grabosky, Rutgers University, New Brunswick, NJ

**3:00 †Maximum Tree Size for Species of Urban Trees in Northern New Jersey Communities.** J. Sanders\* and J. Grabosky, Rutgers University, New Brunswick, NJ

**3:15 Break – Coffee/Beverages on your own**

MODERATOR: W.T. Hlubik, NEASHS  
President-Elect

**3:45 Ten-Year Performance of Three Dwarf Apple Rootstocks with Cameo™ Apple.** J.M. Clements, W.R. Autio, University of Massachusetts; W. Cowgill\*, and D. Ward, Rutgers University, New Brunswick, NJ

**4:00 Harvest Characteristics and Other Attributes of Fall Broccoli.** M. Infante-Casella\*, M. Henninger, and M. Cummings, Rutgers University, New Brunswick, NJ

**4:15 Red Pepper Cultivar Evaluations for the Summer and Fall Market.** W. Kline\* and C.A. Wyenandt, Rutgers University, New Brunswick, NJ

**4:30 Characterizing Plant Architecture in 3D Using Magnetic Data Acquisition and Multi-Scale Graph Analysis.** J.S. Caplan\*, C.A. Faillace, J. Lafond, J. Grabosky, and J.G. Ehrenfeld (deceased), Rutgers University, New Brunswick, NJ

**4:45 NEASHS Business Meeting and Student Awards**

5:45 Adjourn

---

---

**WEDNESDAY EVENING JANUARY 4**

---

---

**NEWSS / NEASHS SOCIAL**

LOCATION: Hamilton Room  
TIME: 6:30 p.m. to 8:30 p.m.

---

---

**THURSDAY MORNING JANUARY 5**

---

---

**Section: STUDENT PRESENTATIONS**

LOCATION: Society Hill Ballroom C&D  
TIME: 8:30 a.m. to 11:00 a.m.  
MODERATORS: Katherine Ghantous  
University of Massachusetts  
Amherst, MA  
Neith Little  
Cornell University  
Ithaca, NY

**\*SPEAKER**

**8:30 Invasive Potential of Bioenergy Crops  
Using the New APHIS Assessment:  
How Risky is Renewable Energy? L.L.  
Smith\* and J.N. Barney, Virginia Tech,  
Blacksburg, VA**

- 8:45** **Investigations of Potential Biological and Chemical Controls for Silvery Thread Moss on Putting Greens.** A. Post\*, S. Askew, and D. McCall, Virginia Tech, Blacksburg, VA
- 9:00** **Natural History Survey of the "Invasive" *Miscanthus sinensis* Populations of Eastern North America.** R.F. Dougherty\*, L. Quinn, T. Voigt, B. Endres, and J.N. Barney, Virginia Tech, Blacksburg, VA
- 9:15** **Do Deer Browse on Invasive Exotic Plants? Deer Preference Trial Results For Native and Invasive Exotic Plants in Pennsylvania.** K.M. Averill\* and D. Mortensen, Penn State, University Park, PA
- 9:30** **Economics, Efficacy, and Non-Target Effects of Managing the Forest Understory Invader *Microstegium vimineum*.** D. Tekiela\*, A. Post, S. Askew, and J.N. Barney, Virginia Tech, Blacksburg, VA
- 9:45** **Coffee Break**
- 10:15** **Nitrogen-Enhanced Efficacy of Mesotrione and Topramezone for Smooth Crabgrass (*Digitaria ischaemum*) Control.** M. Elmore\*, J.T. Brosnan, G.K. Breeden, and P.A. Jones, University of Tennessee, Knoxville, TN
- 10:30** **Quantifying Vapor Drift of Dicamba Herbicides Applied to Soybean.** J.F. Egan\* and D. Mortensen, Penn State, University Park, PA

**10:45 Nicosulfuron-Resistant Johnsongrass Exhibits Differential Sensitivity to Glyphosate.** A.N. Smith\* and E.S. Hagood, Virginia Tech, Blacksburg, VA

---

---

***THURSDAY MORNING JANUARY 5***

---

---

**Section: ORNAMENTALS**

LOCATION: Ballroom E  
TIME: 8:30 a.m. to 11:00 a.m.  
CHAIR: Chris Becker  
BAAR Scientific LLC  
Romulus, NY  
CHAIR-ELECT: Kathleen Hester  
The IR-4 Project  
Exton, PA

**\*SPEAKER**

- 8:30 Postemergence Control of Monocotyledonous Weeds in Selected Container-Grown Ornamentals.** A.F. Senesac\*, Cornell University, Riverhead, NY
- 8:45 Safety and Efficacy of Mulch and Mulch / Herbicide Combinations in Pansy Beds.** J.C. Neal\*, C. Harlow, and B. Fair, North Carolina State University, Raleigh, NC
- 9:00 Spray Volume and Droplet Size Affect Herbicide Deposition on Container Surfaces.** J. Atland\* and R. Derksen, USDA-ARS, Wooster, OH

- 9:15 Tolerance of Conifers to Mesotrione Alone or Combined with Other Herbicides.** J.F. Ahrens\* and T.L. Mervosh, Connecticut Agricultural Experiment Station, Windsor, CT
- 9:30 Section Business Meeting, and Election of Chair-Elect**
- 9:45 Coffee Break**
- 10:15 IR-4 Project Priority Discussion**
- 11:00 Adjourn**

---

---

***THURSDAY MORNING JANUARY 5***

---

---

**Section: NEASHS PAPERS**

LOCATION: Bromley/Claypoole  
TIME: 8:30 a.m. to 11:30 a.m.  
MODERATOR: Nick Polanin NEASHS  
Secretary/Treasurer

**\*SPEAKER**

- 8:30 Sustainable Cranberry Production with Reduced Phosphorus Applications.** C. DeMoranville\*, University of Massachusetts Amherst, Amherst, MA

- 8:45 Control of Downy Mildew (*Pseudoperonospora cubensis*) in Organically -Produced Cucumber with Biopesticides.** M.T. McGrath, G.M. Fox, and L.K. Hunsberger\*, Cornell University, Riverhead, NY
- 9:00 Lima Bean Breeding and Genetics Research at the University of Delaware.** E.G. Ernest,\* T.A. Evans, N.F. Gregory, and R.J. Wisser, University of Delaware, Georgetown, DE
- 9:15 Evaluating Cranberry Progeny for Field Fruit Rot Resistance.** J. Johnson-Cicalese\*, N. Vorsa, J. Polashock, L. Georgi, and M. Tadych, Rutgers University and USDA-ARS, New Brunswick, NJ
- 9:30 Annie's Project NJ – Helping Women Farmers Take the Risk Out of Farm Management.** J. Carleo\*, R. Brumfield, B. O'Neill, N. Polanin, S. Komar, and R. Mickel, Rutgers University, New Brunswick, NJ
- 9:45 Coffee Break**
- 10:15 Progress in Understanding Cold-Hardiness, Acclimation, and Deacclimation in Diverse Blueberry Germplasm.** M.K. Ehlenfeldt\*, L.J. Rowland, E.L. Ogden, and B. Vinyard. USDA-ARS, Marucci Center for Blueberry and Cranberry Research and Extension, Chatsworth, NJ

- 10:30 Ornamental Plant Breeding in the Private Sector.** J. Janes\*, M. Scheiber, and M. Dobres, NovaFlora Inc., West Grove, PA
- 10:45 Proanthocyanidin Content and Composition in the Cranberry Ovary from Flower to Mature Fruit: The Potential Role in Fruit Rot Resistance.** N. Vorsa\*, J. Johnson-Cicalese, S. Shah, and A. Singh, Rutgers University, New Brunswick, NJ
- 11:00 Specialty Greens and Herbs - Surveying Ethnic Consumer Preferences for the East Coast.** R. Govindasamy, J. Simon, W. Sciarappa\*, R. Van Vranken, A. Ayeni, P. Nitzsche, B. Schilling, S. Komar, and V. Puduri, Rutgers University; K.M. Kelley, Penn State University; F. Mangan, University of Massachusetts; Shouan Zhang and G. McVaoy, University of Florida
- 11:15 Injury from Delayed Applications of Dichlobenil on Four Cranberry Varieties.** H.A. Sandler\*, UMass Cranberry Station, East Wareham, MA
- 11:30 Adjourn**

---

---

**THURSDAY MORNING JANUARY 5**

---

---

**Section: FRUITS AND VEGETABLES**

LOCATION: Cook Room  
TIME: 10:15 a.m. to 11:45 p.m.  
CHAIR: Rick Dunst  
Cornell University  
Portland, NY  
CHAIR-ELECT: Dan Kunkel  
Rutgers University  
Princeton, NJ

**\*SPEAKER**

- 10:15 Fruit Tree Tolerance to Alion™  
Herbicide.** M. Mahoney\*, D. Unland, and  
B. DeWeese. Bayer CropScience,  
Oxford, MD
- 10:30 The IR-4 Project: Update on Weed  
Control Projects (Food Uses).** M.  
Arsenovic\*, D. Kunkel, and J. Baron, IR-4  
Project, Princeton, NJ
- 10:45 Sweet Corn Weed Control: No-till, No  
Atrazine, No Way?** D.D. Lingenfelter\*,  
M.J. VanGessel, B.A. Scott, and Q.  
Johnson, Penn State, University Park, PA
- 11:00 Sulfentrazone For Lima Beans: Are We  
Charging Forward?** M.J. VanGessel\*,  
B.A. Scott, and Q. Johnson, University of  
Delaware, Georgetown, DE

- 11:15 Preemergent Combinations of Herbicides for Weed Control in Wild Blueberry Fields.** D.E. Yarborough\* and J.L. D'Appollonio, University of Maine, Orono, ME
- 11:30 Discussion, Section Business Meeting, and Election of Chair-Elect**
- 11:45 Adjourn**

---

---

***THURSDAY AFTERNOON JANUARY 5***

---

---

**Section: VEGETATION MANAGEMENT AND RESTORATION**

LOCATION: Ballroom E  
TIME: 1:00 p.m. to 4:30 p.m.  
CHAIR: Brian McDonnell  
National Park Service  
Bushkill, PA  
CHAIR-ELECT: Jon Johnson  
Penn State  
University Park, PA

**\*SPEAKER**

**Swallow-wort Mini-Symposium**

- 1:00 The Swallow-worts: Where to Next?** A. DiTommaso\*, Cornell University, Ithaca, NY
- 1:20 Pale and Black Swallow-wort Growth and Survival in New York State.** K.M. Averill\* and A. DiTommaso, Penn State University, University Park, PA

- 1:40 Approaches for Swallow-wort Control - Deciding How to Begin.** N.P. Cain\* and T.L. Mervosh, Cain Vegetation, Acton, ON
- 2:00 Swallow-wort (*Vincetoxicum* spp.) Biological Control Update.** L.R. Milbrath\*, USDA-ARS, Ithaca, NY
- 2:20 Panel Discussion**
- 2:30 Goatsrue Control Program in Pennsylvania.** M.A. Bravo\*, J. Zoschg, L. Ross, and I. Bowers, Pennsylvania Department of Agriculture, Harrisburg, PA
- 2:45 Comparison of Herbicides for Early Season Control of Mile-a-Minute and Impact on Non-Target Vegetation.** A.E. Gover\* and J. Huffman, Penn State, University Park, PA
- 3:00 Break – *Coffee/Beverages on your own***
- 3:30 F9007: A New Herbicide for Weed Control in Pasture and Wheat.** J.P. Reed\*, T. Mize, G. Stratman, and B. Neuberger, FMC, North Little Rock, AR
- Break – *Coffee/Beverages on your own***
- 3:45 Absorption and Translocation of <sup>14</sup>C-Aminocyclopyrachlor in Three Aquatic Species.** R.L. Roten\* and R.J. Richardson, North Carolina State University, Raleigh, NC
- 4:00 Turion Biology of Monoecious *Hydrilla verticillata*.** R.J. Richardson\* and S. Hoyle, North Carolina State University, Raleigh, NC

**4:15 Discussion, Section Business Meeting,  
and Election of Chair-Elect**

**4:30 Adjourn**

---

---

***THURSDAY AFTERNOON JANUARY 5***

---

---

**SYMPOSIUM**

**Moving Beyond Rotating Modes of Action:  
Advancing the Concept and Application of  
Integrated Weed Management**

LOCATION: Ballroom C&D  
TIME: 1:00 p.m. to 4:30 p.m.  
MODERATORS: Richard Smith  
University of New Hampshire  
Durham, NH  
Matthew Ryan  
Penn State  
University Park, PA

**\*SPEAKER**

**1:00 Diversification, Soil Quality and  
Integrated Weed Management.** E.R.  
Gallandt\*, University of Maine, Orono, ME

**1:30 Clashing Perspectives Limit IWM  
Adoption in the Northeast.** D.D.  
Lingenfelter\*, Penn State, University Park,  
PA

**2:00 IWM: What the Heck is That?** J.L.  
Lindquist\*, University of Nebraska,  
Lincoln, NE

- 2:30 Interactions that Matter: Improving Efficacy with Strategic Combinations of Cultural Weed Management Practices.** M.R. Ryan\*, D. Mortensen, J. Teasdale, R. Smith, S. Mirsky, and W. Curran, Penn State, University Park, PA
- 3:00 Break – *Coffee/Beverages on your own***
- 3:30 Are Organic Farming and Herbicide Resistance the Last Hopes for IWM? A View from Canada.** S. Shirliffe\*, University of Saskatchewan, Saskatoon, SK
- 4:00 Why are We Still Talking About Weeds? Addressing the Roots of a Perennial Problem.** R.G. Smith\*, University of New Hampshire, Durham, NH

---

---

***THURSDAY AFTERNOON JANUARY 5***

---

---

**NEWSS 66<sup>th</sup> ANNUAL BUSINESS MEETING AND AWARDS**

**LOCATION:** Society Hill Ballroom C&D

**TIME:** 4:45 p.m. to 6:15 p.m.

**Call to order:** M. VanGessel

Acceptance of the Minutes from the 65<sup>th</sup> Annual Business Meeting

## **NEWSS Awards**

Presenter: Hilary Sandler  
UMass Cranberry Station  
East Wareham, MA

### ***Award of Merit***

Dr. Ronald L. Ritter

### ***Fellow Award***

Dr. Timothy Dutt

### ***Service Recognition Award***

Ms. Sherrilynn Novak

### ***Robert D. Sweet Outstanding Graduate Student Award***

Matthew A. Cutulle (Ph.D.)  
Jose Javier Vargas (M.S.)

#### Awards Committee Reports:

- Collegiate Weed Contest Winners - G. Armel
- Graduate Student Presentation Awards - H. Sandler
- Research Poster Contest - Q. Johnson
- Photo Contest - G. Armel

Necrology Report - M. Bravo

Executive Committee Reports (available on web)

President's Comments - M. VanGessel

Secretary/Treasurer Update - M. Bravo

Audit Committee Report - J. Steffel

Archive Report - D. Kunkel

CAST Update – R. Prostack

Other Old Business

Officer Changeover and Presentation of the  
Gavel

**New Business** - A. DiTommaso

Resolutions

Nominating Committee Report - D. Yarborough  
Election of the Vice President

Appointment (2) and Election (3) of the 2012  
Nominating Committee

Resolution Committee Appointments

Weed Contest 2012 - TBD

WSSA 2012 Annual Meeting – J. Barney

Change of Treasurer/Secretary to two positions,  
Treasurer and Membership Committee

Announcement: Poster Take Down

**Next Meeting:** February 4-7, 2013  
Monday through Thursday  
Location: Hilton, Baltimore, MD

**Adjourn**

---

---

***THURSDAY EVENING JANUARY 5***

---

---

**INDUSTRY NIGHT CAP**  
**AND DESSERT**  
**NEWSS / NEASHS SOCIAL**

LOCATION: Hamilton Ballroom  
TIME: 9:00 p.m. to 11:00 p.m.

**SPONSORED BY:**  
**BASF Corp.**  
**Bayer CropScience**  
**FMC**  
**Monsanto**  
**PBI Gordon**  
**Syngenta**

---

---

***FRIDAY MORNING JANUARY 6***

---

---

**Section: TURFGRASS AND PLANT**  
**GROWTH REGULATORS**

LOCATION: Ballroom E  
TIME: 8:15 a.m. - 12:00 p.m.  
CHAIR: James Brosnan  
University of Tennessee  
Knoxville, TN  
CHAIR-ELECT: Aaron Patton  
Purdue University  
West Lafayette, IN

**\*SPEAKER**

- 8:15 Methiozolin Programs for Annual Bluegrass Control in Creeping Bentgrass Putting Greens in Tennessee.** J.T. Brosnan\* and G. Breeden, University of Tennessee, Knoxville, TN
- 8:30 Annual Bluegrass Control on Golf Putting Greens with Spring Applications of Methiozolin.** S. Askew\* and S.-J. Koo, Virginia Tech, Blacksburg, VA

- 8:45 Use of Methiozolin for Annual Bluegrass (*Poa annua* L.) Control on Creeping Bentgrass (*Agrostis stolonifera*) Greens.** K.A. Venner\*, S. Hart, S. Askew, and C. Mansue, Rutgers University, New Brunswick, NJ
- 9:00 Seedhead Suppression of an Annual Bluegrass Putting Green.** J. Borger\*, M. Naedel, and K. Hivner, Penn State University, University Park, PA
- 9:15 Ground Ivy Control as Affected by Mowing Prior to or Following Herbicide Applications.** A.J. Patton\* and D. Weisenberger, Purdue University, West Lafayette, IN
- 9:30 Broadleaf Weed Control in Turfgrass Using Alternatives to Synthetic Herbicides.** D. Linde\* and S. McDonald, Delaware Valley College, Doylestown, PA
- 9:45 Use of Environmental Genomics for Natural Products Discovery of Novel Herbicides.** J.T. Kao-Kniffin\*, Cornell University, Ithaca, NY
- 10:00 Coffee Break**
- 10:30 Influence of Early Applications on Annual Bluegrass Seedhead Suppression with Ethephon and Mefluidide.** S. Askew\* and A. Smith, Virginia Tech, Blacksburg, VA

- 10:45 Tall Fescue (*Festuca arundinacea*) Tolerance to Spring and Fall Amicarbazone Applications.** G.K. Breeden\*, J. Brosnan, and P. McCullough, University of Tennessee, Knoxville, TN
- 11:00 Mesotrione and Amicarbazone Combinations for Annual Bluegrass (*Poa annua*) Control.** M.T. Elmore\*, J. Brosnan, and G. Breeden, University of Tennessee, Knoxville, TN
- 11:15 Potential Antagonism of Sulfentrazone and Fenoxaprop Tank-Mixes for Goosegrass Control.** A.J. Patton\*, D. Weisenberger, J. Brosnan, and G. Breeden, Purdue University, West Lafayette, IN
- 11:30 Cool-Season Turfgrass Reseeding Intervals for Methiozolin.** P. McCullough and D. Gomez de Barreda\*, University of Georgia, Griffin, GA
- 11:45 Discussion, Section Business Meeting, and Election of Chair-Elect**
- 12:00 Adjourn**

---

---

**FRIDAY MORNING JANUARY 6**

---

---

**Section: AGRONOMY**

LOCATION: Society Hill Ballroom C&D  
TIME: 8:15 a.m. - 12:00 p.m.  
CHAIR: Keith Burnell  
Syngenta Crop Protection  
Penfield, NY  
CHAIR-ELECT: Richard Richtmyer  
Cornell University  
Ithaca, NY

**\*SPEAKER**

- 8:15 Enlist Corn Tolerance and Weed Control with PRE Followed by POST Herbicide Programs.** B.D. Olson\*, S. Ditmarsen, C. Gallup, M. Melichar, and P. Prasifka, Dow AgroSciences LLC, Geneva, NY
- 8:30 Reduced Rate Residual Herbicides Prevent Dandelion Establishment in Zone-Tillage Corn and Soybeans.** R.R. Hahn\*, R. Richtmyer III, and J. Orłowski, Cornell University, Ithaca, NY
- 8:45 Zemax™: A New Mesotrione plus S-metolachlor Formulation in Corn.** E. Hitchner\*, R. Lins, M. Urwiler, and G. Vail, Syngenta Crop Protection, Elmer, NJ

- 9:00 Performance of F9310 and F9316 in the Northeast PRE and POST Corn Trials in 2010 and 2011.** J.P. Reed\*, J.S. Wilson, G.G. Stratman, B.A. Neuberger, and T.W. Mize, FMC Corporation, Philadelphia, PA
- 9:15 Exploring Opportunities to Diversify Burndown Options in No-till Crop Production Systems.** W.S. Curran\* and D. Lingenfelter, Penn State, University Park, PA
- 9:30 Defining Geographic and Bioclimatic Distributions of Troublesome Weeds in Grain Crops.** E.M. Buck\*, A. DiTommaso, S.J. Riha, and A.J. McDonald, Cornell University, Ithaca, NY
- 9:45 Herbicide Resistance Education - A Critical Step in Proactive Management.** W.J. Everman\*, L. Glasgow, L. Ingegneri, J. Schroeder, D. Shaw, J. Soteris, J. Stachler, and F. Tardif, North Carolina State University, Raleigh, NC
- 10:00 Coffee Break**
- 10:30 Stewardship of Dicamba in Dicamba-Tolerant Cropping Systems.** W.E. Thomas\*, S. Bowe, L. Bozeman, M. Staal, T. Cannan, and S. Murdock, BASF Corporation, Triangle Park, NC
- 10:45 Efficacy of F9310 and Sulfentrazone Premixes in the Northeast Soybean Trials in 2011.** J.P. Reed\*, J.S. Wilson, G. G. Stratman, B.A. Neuberger, and T. W. Mize, FMC Corporation, Philadelphia, PA

- 11:00 Update on HPPD-Resistant Waterhemp and Control Options in Corn and Soybeans.** K.D. Burnell\*, V.K. Shivrain, A. Franssen, and G. Vail, Syngenta Crop Protection, Penfield, NY
- 11:15 Selectivity of Glyphosate and HPPD Inhibiting Herbicides in a New Soybean Event.** M. Mahoney\*, J. Allen, and J. Hinz, Bayer CropScience, Oxford, MD
- 11:30 Anthem™ and Anthem ATZ™ -Two New Herbicides for Pre-emergence and Post-emergence Control of Key Broadleaf and Grass Weed Pests.** J.S. Wilson\*, T.W. Mize, T. Martin, J.P. Reed, G.G. Stratman, and B.A. Neuberger, FMC Corporation, Philadelphia, PA
- 11:45 Discussion, Section Business Meeting, and Election of Chair-Elect**
- 12:00 Adjourn**

---



---

## INDEX OF HERBICIDES MENTIONED IN THE 2012 PROGRAM

---



---

<u>Common Name</u>	<u>Trade Name</u>
2,4-D .....	many
amicarbazone .....	Dinamic
aminocyclopyrachlor .....	Imprelis
aminopyralid .....	Milestone
atrazine .....	Aatrex, many
bensulide .....	Bensumec, Prefar
bentazon .....	Basagran
bispyribac-sodium .....	Regiment, Velocity
clopyralid .....	Lontrel, Stinger, Transline
dicamba .....	Banvel, many
dichlobenil .....	Barrier, Casoron, others
dichlorprop .....	Weedone 2,4-DP
dimethenamid-p .....	Outlook, Tower
dithiopyr .....	Dimension
diuron .....	Karmex
fenoxaprop .....	Acclaim, Horizon, others
fluazifop-p .....	Fusilade, Ornamec, others
flumioxazin .....	BroadStar, Chateau, Valor
fluthiacet-methyl .....	Cadet
fomesafen .....	Reflex
glufosinate .....	Finale, Ignite, Rely
glyphosate .....	Glyphomax, Glyphos, Roundup
.....	Touchdown, many
halosulfuron .....	Sandea, SedgeHammer
hexazinone .....	Pronone, Velpar
imazamox .....	ClearCast, Raptor, Odessey
imazapic .....	Cadre, Plateau
imazapyr .....	Arsenal, Habitat, others
indaziflam .....	Alion, Specticle
isoxaben .....	Gallery
isoxaflutole .....	Balance flexx
linuron .....	Linex, Lorox
mecoprop (MCP) .....	various
mefluidide .....	Embark, Vistar
mesotrione .....	Callisto, Tenacity
metsulfuron .....	Ally, Cimarron, Escort, others
nicosulfuron .....	Accent

oxadiazon .....	Ronstar
pelargonic acid.....	Scythe, others
pendimethalin .....	Prowl, Pendulum
prodiamine.....	Barricade, Factor
rimsulfuron.....	Matrix, Resolve, others
saflufenacil.....	Sharpen, Treevix, Kixor
sethoxydim .....	Poast, Segment, others
s-metolachlor .....	Dual Magnum, Medal, others
sulfentrazone .....	Authority, Dismiss, Spartan
sulfometuron-methyl.....	Oust
sulfosulfuron .....	Outrider, Maverick
tembotrione.....	Laudis
terbacil .....	Sinbar
topramezone.....	Impact
triclopyr .....	Garlon, Turflon
trifluralin .....	Treflan, many

## COMBINATION PRE-MIX HERBICIDES

FreeHand.....dimethenamid-P + pendimethalin  
SureStart.....acetochlor + clopyralid + flumetsulam

## PLANT GROWTH REGULATORS

Common Name ..... Trade Name

ethephon..... Ethrel, Florel  
paclobutrazol ..... Bonzi, Clipper, Trimmit  
trinexapac-ethyl ..... Palisade, Primo

## EXPERIMENTAL HERBICIDES

Anthem.....F9310, pyroxasulfone + fluthiacet-methyl  
Anthem ATZ.....F9316, pyroxasulfone + atrazine +  
fluthiacet-methyl  
Enlist Duo.....2,4-D choline + glyphosate DMA  
..... methiozolin  
F9007.....carfentrazone + metsulfuron  
Zemax.....mesotrione + s-metolachlor

Information on herbicide common and trade names used in the program was obtained from **WSSA Herbicide Handbook, 9<sup>th</sup> Edition 2007**, edited by **S.A. Senseman**, and is provided as a courtesy to meeting attendees.

Trade names may change; interested persons should confirm active trade names with company representatives if desired.

## Personal Time Schedule

Time	Wednesday	Thursday	Friday
8:00			
8:15			
8:30			
8:45			
9:00			
9:15			
9:30			
9:45			
10:00			
10:15			
10:30			
10:45			
11:00			
11:15			
11:30			
11:45			
Noon			
1:00			
1:15			
1:30			
1:45			
2:00			
2:15			
2:30			
2:45			
3:00			
3:15			
3:30			
3:45			
4:00			
4:15			
4:30			
4:45			
5:00			
5:45			
6:00			
6:30			

## NEWS PAST PRESIDENTS

GILBERT H. AHLGREN .....	1947-49
ROBERT D. SWEET .....	1949-50
HOWARD L. YOWELL.....	1950-51
STEPHEN M. RALEIGH.....	1951-52
CHARLES E. MINARIK.....	1952-53
ROBERT H. BEATTY.....	1953-54
ALBIN O. KUHN.....	1954-55
JOHN VAN GELUWE .....	1955-56
L. DANIELSON.....	1956-57
CHARLES L. HOVEY.....	1957-58
STANFORD N. FERTIG.....	1958-59
GORDON UTTER.....	1959-60
E. M. RAHN.....	1960-61
LAWRENCE SOUTHWICK.....	1961-62
DONALD A. SHALLOCK.....	1962-63
ANTHONY J. TAFURO.....	1963-64
ROBERT A. PETERS.....	1964-65
GIDEON D. HILL.....	1965-66
RICHARD D. ILNICKI.....	1966-67
JOHN E. GALLAGHER.....	1967-68
JOHN A. MEADE.....	1968-69
HOMER M. LEBARON.....	1969-70
JOHN F. AHRENS.....	1970-71
GEORGE H. BAYER.....	1971-72
ARTHUR BING.....	1972-73
RALPH HANSEN.....	1973-74
WALTER A. GENTNER.....	1974-75
HENRY P. WILSON.....	1975-76
RICHARD J. MARRESE.....	1976-77
C. EDWARD BESTE.....	1977-78
JAMES D. RIGGLEMAN.....	1978-79
JAMES V. PAROCHETTI.....	1979-80
M. GARRY SCHNAPPINGER.....	1980-81
RAYMOND B. TAYLORSON.....	1981-82
STEPHAN DENNIS.....	1982-83
THOMAS L. WATSCHKE.....	1983-84
JAMES C. GRAHAM.....	1984-85
RUSSELL R. HAHN.....	1985-86
EDWARD R. HIGGINS.....	1986-87
MAXWELL L. MCCORMACK, JR.....	1987-88
ROY R. JOHNSON.....	1988-89
STANLEY F. GORSKI.....	1989-90
JOHN B. DOBSON.....	1990-91
PRASANTA C. BHOWMIK.....	1991-92

STANLEY W. PRUSS .....	1992-93
RONALD L. RITTER .....	1993-94
WAYNE G. WRIGHT .....	1994-95
BRADLEY A. MAJEK .....	1995-96
THOMAS E. VRABEL .....	1996-97
JOSEPH C. NEAL .....	1997-98
DAVID B. VITOLO .....	1998-99
A. RICHARD BONANNO .....	1999-00
BRIAN D. OLSON .....	2000-01
JEFFREY F. DERR .....	2001-02
DAVID J. MAYONADO .....	2002-03
D. SCOTT GLENN .....	2003-04
ROBIN R. BELLINDER .....	2004-05
TIMOTHY E. DUTT .....	2005-06
WILLIAM S. CURRAN .....	2006-07
RENEE J. KEESE .....	2007-08
JERRY J. BARON .....	2008-09
DAVID E. YARBOROUGH .....	2009-10
HILARY A. SANDLER .....	2010-11

## NOTES

## NOTES

## NOTES

## NOTES

## NOTES

## NOTES